

LIFTS **ALL** flexicrane



LIFTING WITH FLEXICRANE

Lifts All AB is one of the world's leading manufacturers of lifting tools. Our wide product range supplies industries all over the globe with tailor-made ergonomic solutions. We lift all!

Ceiling mounted

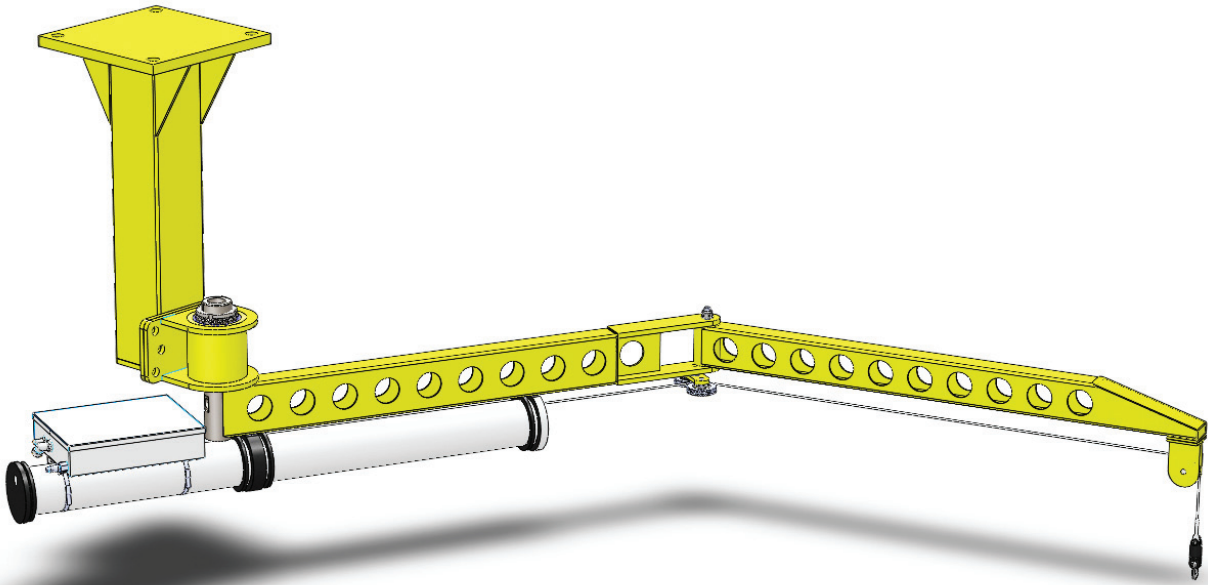

FLEXICRANE

The multifaceted FlexiCrane follows you wherever you go - smoothly and silently!

A lift system for Your workplace

FlexiCrane is mounted with a steel pillar on the wall, in the ceiling or on the floor, depending on the design of the workplace. The length of the pillar is customised. There is always enough space for a FlexiCrane with a tailor-made gripper!

Easy installation

Thanks to the light weight design and the handy size FlexiCrane is easily installed in no time and therefore at a low cost.

Super ergonomic handling solution

The low weight of the crane combined with low-friction bearings makes it very silent and smooth to work with. Using Lifts All lifting aids does not only save backs, but also time and money.

Energy effective air hoist

Since the crane is driven by compressed air, costs are even saved during the very use of FlexiCrane. Our standby mode costs nothing!

The endlessly rotating crane

Another nice feature about FlexiCrane is that due to the clever design of air intake, the arm can actually rotate, not only a full turn - but endlessly!

GENERAL DATA

Max load: 65 kg

Range: 4 m

Rotation: Unlimited

Size of pillar base: 37x37 cm

Driven by: Compr. air 6-7 bar

Laquered: Red (RAL 3020)

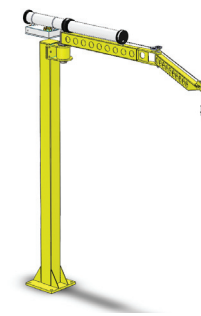

Floor mounted

Pillar length: 50-250 cm

Weight example: 62 kg
(250 cm pillar)



Wall mounted

Pillar length: 50-100 cm



Ceiling mounted

Pillar length: 15-200 cm

MEASUREMENTS (mm)

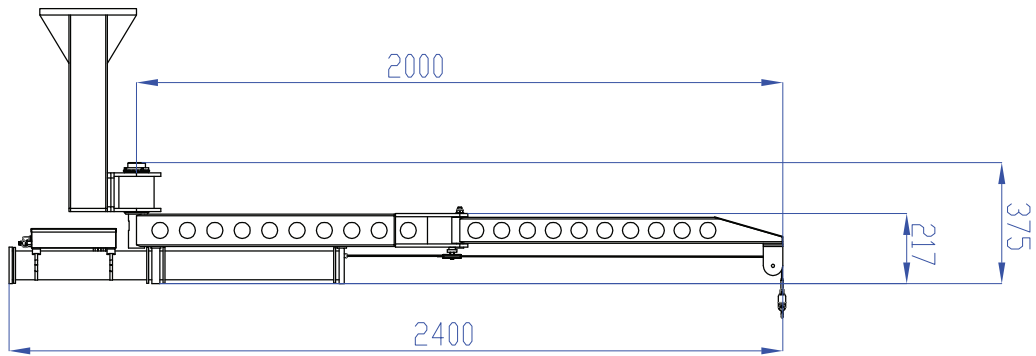

RANGE (mm)

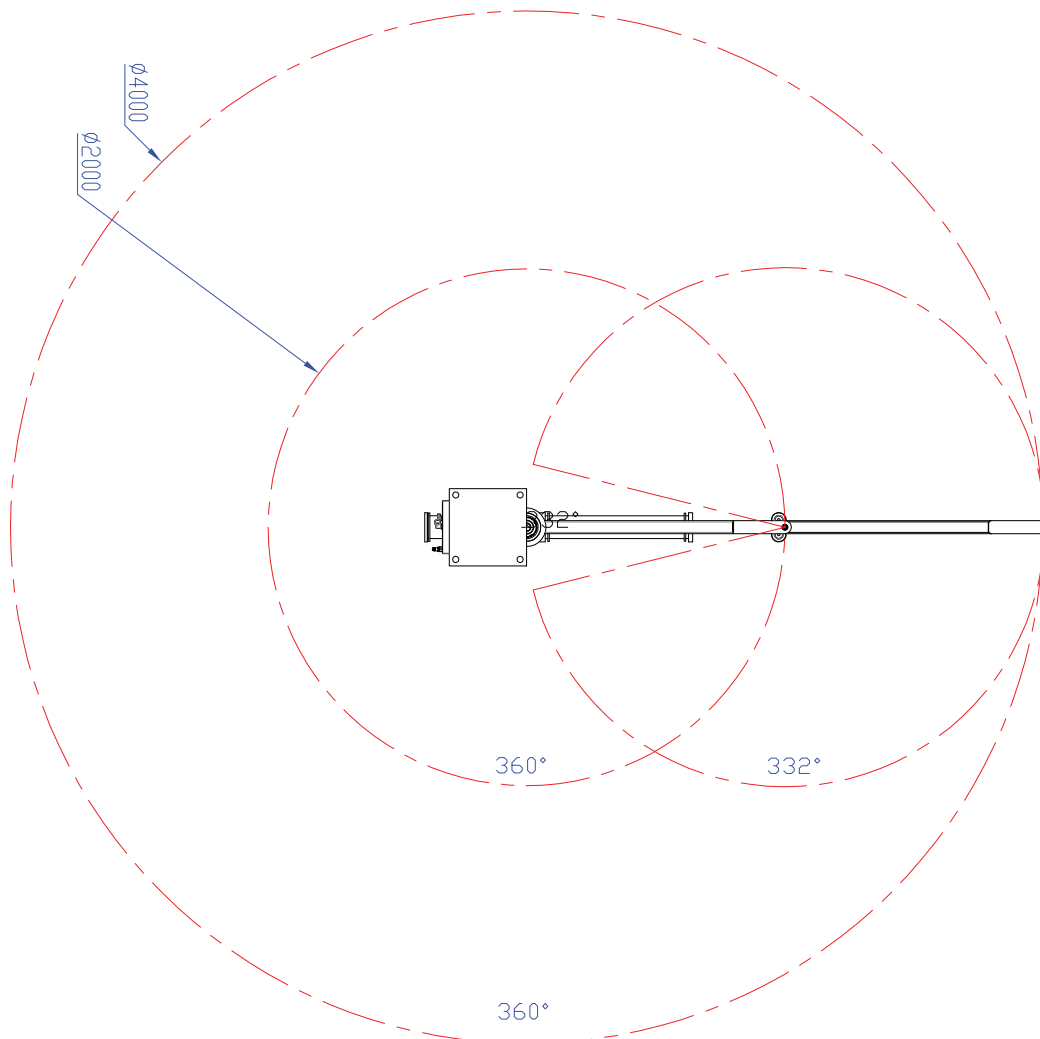

FLEXICRANE MOBILE

The latest version of FlexiCrane is the portable articulated jib crane you have always been looking for. It is just as smooth and silent as the original but with a moveable base, free from attachments to the floor and - of course - still safe and stable during lifting.

Two-step-installation

To install the crane:

1. Put it down on the floor.
2. Plug in the air supply.

Done! The FlexiCrane is now ready to lift whatever you wish up to 65 kg.

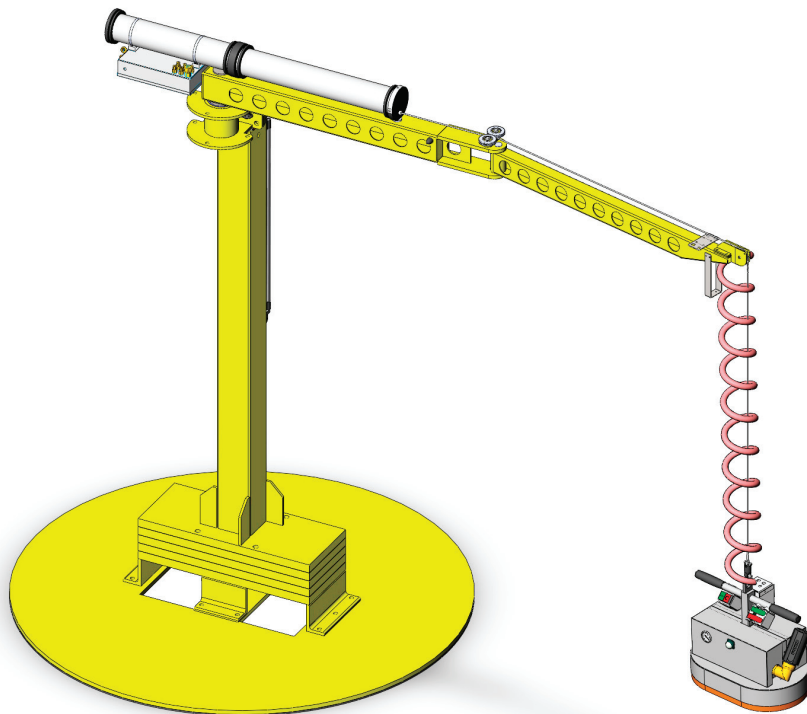

GENERAL DATA

Max load: 65 kg
Range: 4,1 m
Rotation: Unlimited
Total weight: 450 kg (excl. gripper)
Height: 2,15-2,75 m (max
3 m with fixed pillar)
Size of pillar base: Ø1,49 m.
Driven by: Compressed air 6-7 bar
Laqcuered: Red (RAL 3020)

Adaptable to different work stations

The movability of FlexiCrane Mobile creates opportunities for the whole workplace. Adjust the height with the pneumatic switch and you are ready to lift in spaces with low headroom as well as up to that shelf. Complete the integrated Bal-Trol hoist with a hook for your buckets, a vacuum lifter for the carton boxes or why not a mechanical gripper to lift and tilt rolls? The grippers are changed in a minute by the user and tailor-made to optimise the desired handling process. Simple as that!



MEASUREMENTS (mm)

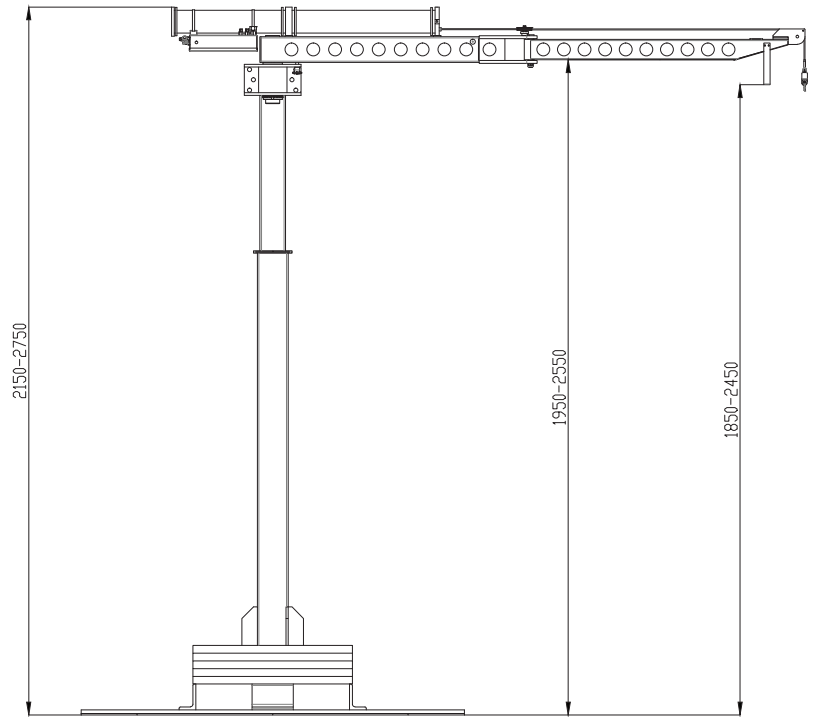

RANGE (mm)

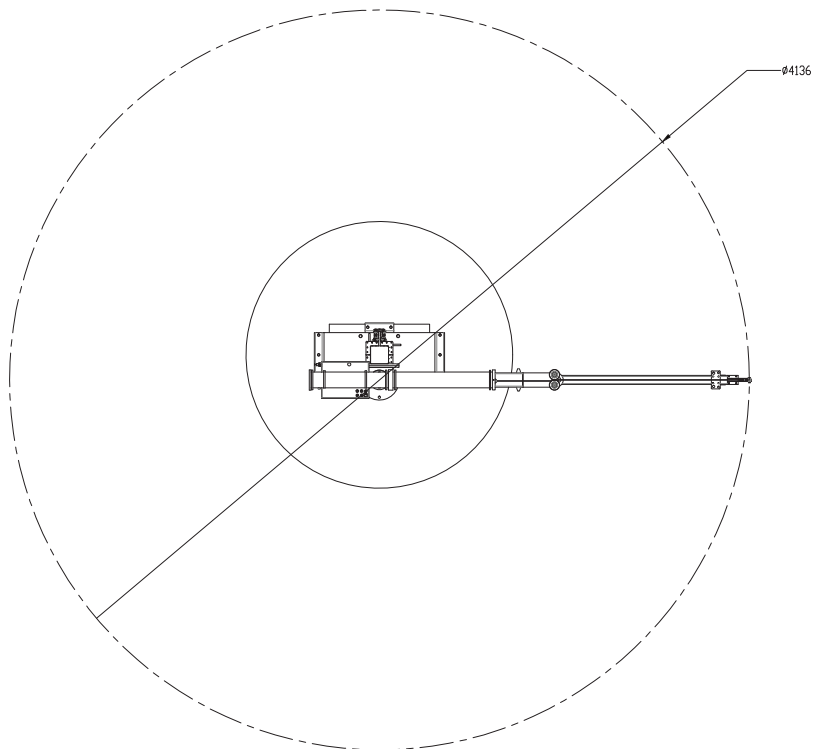

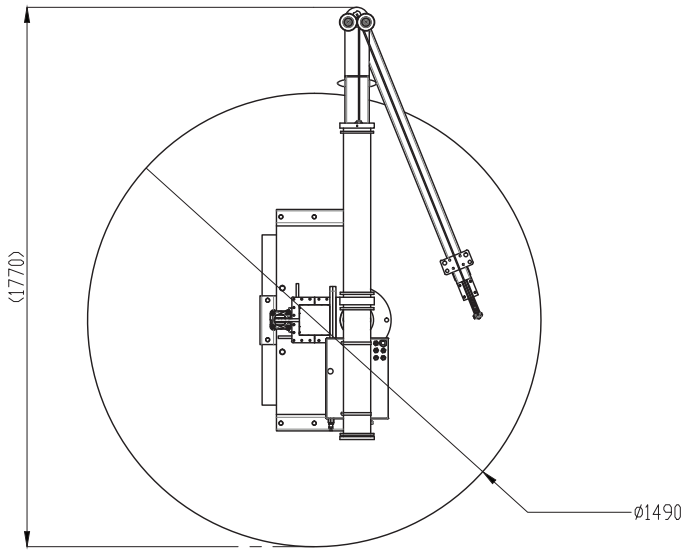

Watch it moving on
[youtube.com/LiftsAll!](https://www.youtube.com/LiftsAll!)

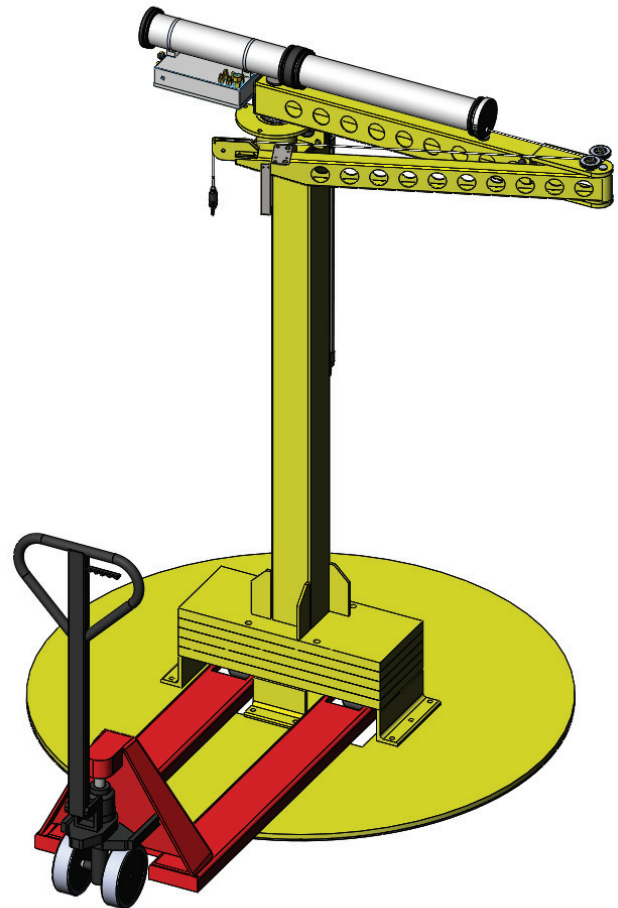

MOVING THE CRANE

Moving FlexiCrane Mobile is as simple as installing: Drive down the pillar to the bottom, unplug the air supply, fold the articulated slewing arm and secure it with a strap. Grab a pallet truck and get moving to the next work station! The convenient size of FlexiCrane also makes it easy to send by truck without having to disassemble (and later reassemble) the whole crane.

TRANSPORT MODE DATA

Total weight: 450 kg
(Bal-Trol, crane arm, pillar and pillar base)

Measurements:
Length: 177 cm
Width: 149 cm
Height: 215 cm

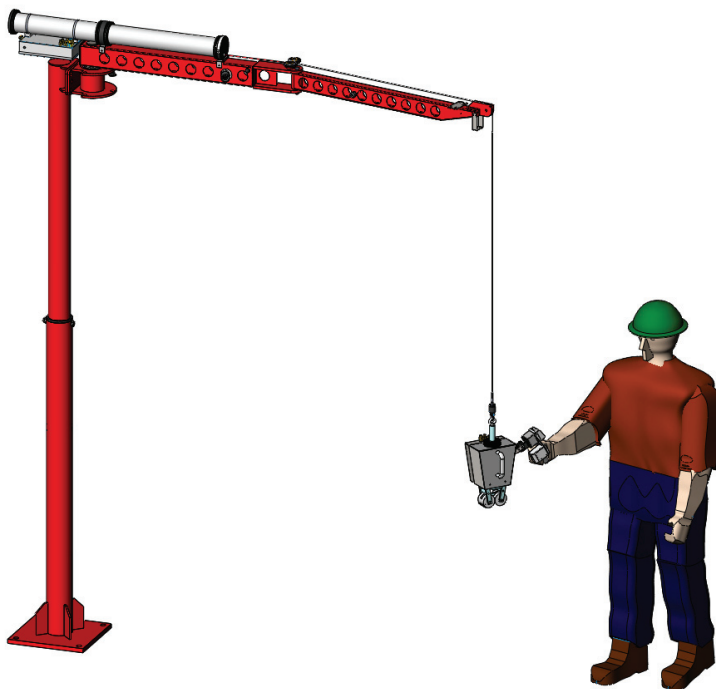
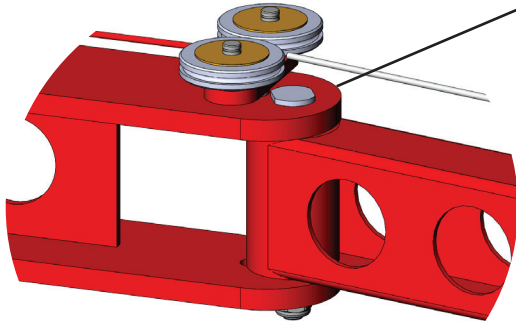

FlexiCrane pillar - adjustable

The pillar is adjustable in height at installation between 2,1 - 3,4 m. The inner pillar is to be drilled and bolted at the desired height.

YOUR COMPLETE LIFTING SYSTEM

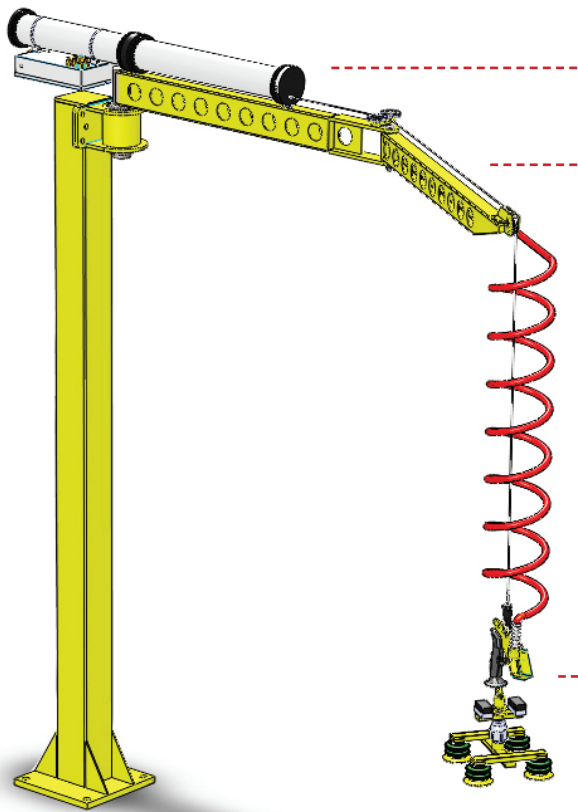

Bal-Trol - The small, flexible lifting cylinder is powered by compressed air only.

FlexiCrane - The multifaceted and smooth crane can be installed anywhere.

Gripper - Tailor-made ergonomic grippers are our specialty. We lift all!

LIFTS **ALL**

Passadvägen 10
SE-177 70 Järfälla
Sweden

Tel: +46 8-754 90 15
Fax: +46 8-626 90 15
E-mail: lifting@liftsall.se
Website: www.liftsall.com